



SARCCUP

SARCCUP Project Updates

SAWPA Member Agencies & SAWPA

PA 23 Committee | April 6, 2021

Item No. 4.A.



SARCCUP Project Update Locations

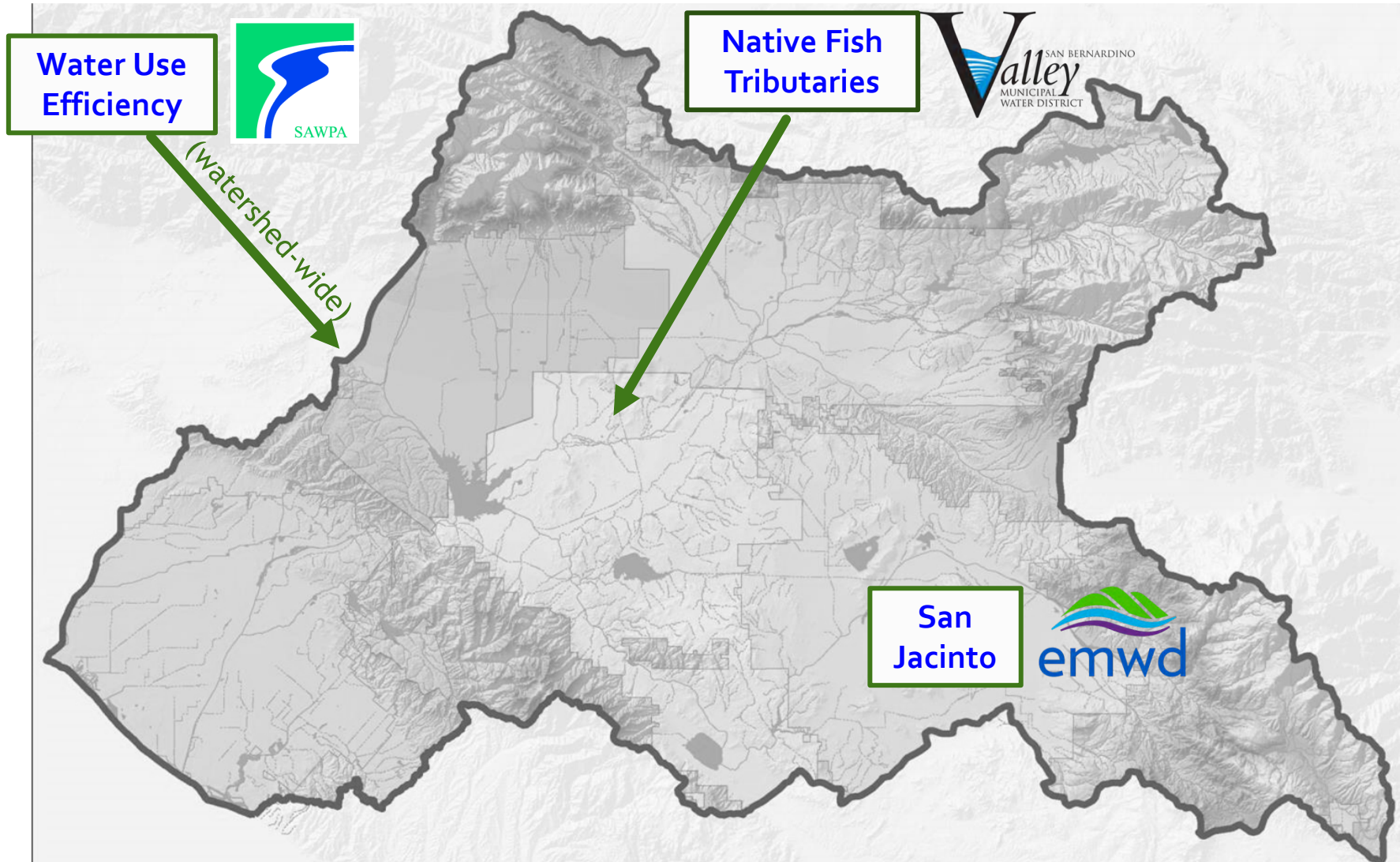



EMWD Updates

San Jacinto Groundwater Basin Facilities

April 2021

Wells 201, 202, & 203 Phase 1B Conveyance Pipelines



Wells 201, 202, 203, & 205 Equipping

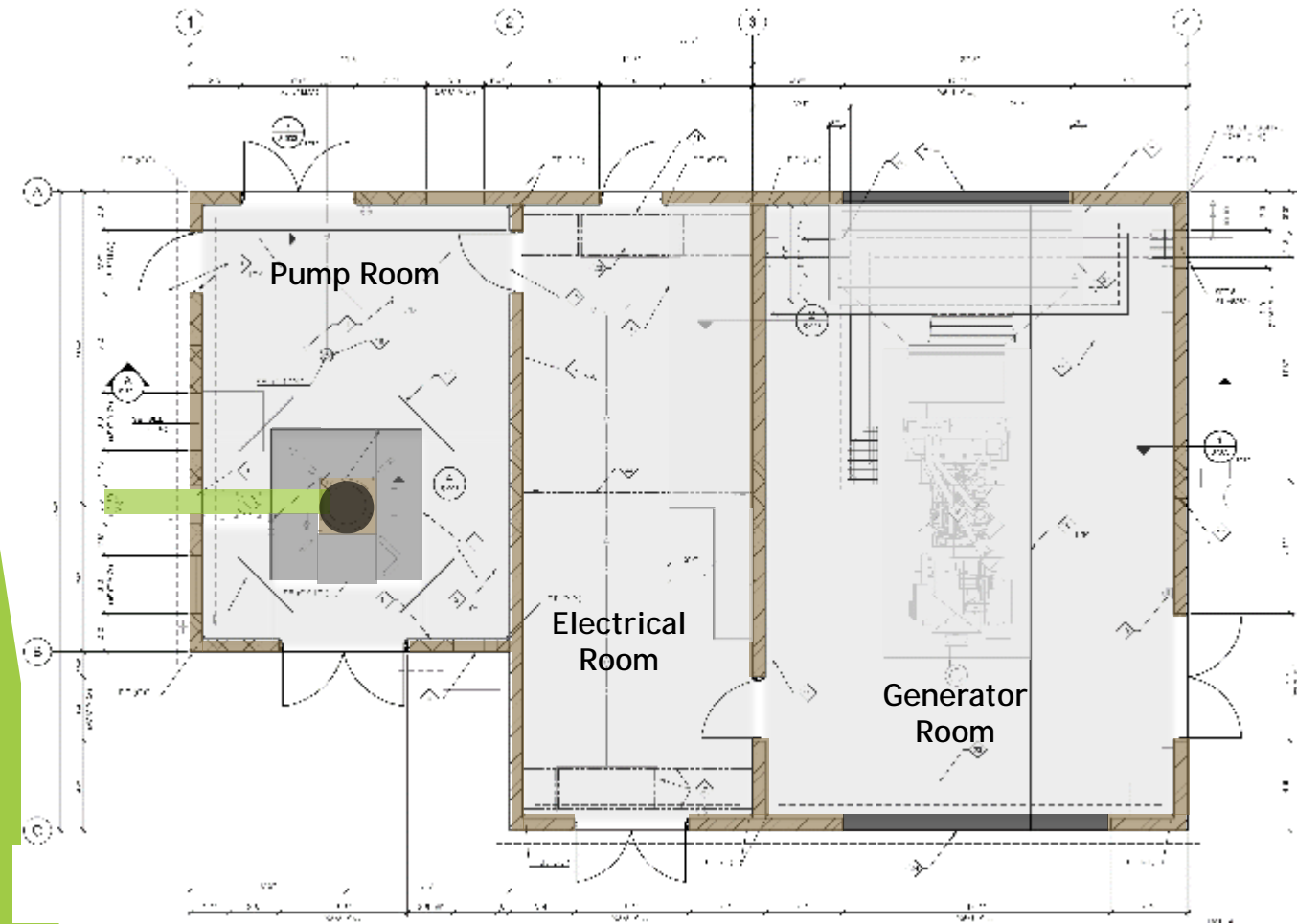

- Design Amendment for architectural color board and wall profile design
- 100% spec comments addressed and back to Field Engineering for bid preparation
- Temporary construction easements in process for shared walls on P/L
- Well 203 drainage easement in process
- Bid March 2021
- O&E May 2021
- Board June 2021

Mountain Avenue West - Construction Progress

- Drilling and development of all eight small monitoring wells and three large nested monitoring wells is complete
- Installation of DG jogging path, landscaping is commencing
- Construction of onsite block wall around inlet piping pads
- Installation of electrical panels and wiring
- Driveways, perimeter fencing, and SCE enclosure construction



Mechanical Piping Pads

Mountain Avenue West - Construction Progress



Mountain Avenue West - Construction Progress



Distribution
Basin

Stilling Basin

Weir between stilling basin and distribution basin

Monitoring Wells Installation



Shallow Monitoring Well SW-06



Monitoring Well MP-01

SBVMWD Updates

Native Fish Habitat Tributaries



Tributary Restoration Projects

▶ Phased Implementation

▶ Phase 1: Hidden Valley and Anza Creeks

- ▶ Working towards 90% Design Package
- ▶ Land Appraisals Underway
- ▶ Site Preparation Underway
- ▶ Seed Collection and Plant Propagation Underway
- ▶ Construction: Fall 2021 - Summer 2022
- ▶ Start Monitoring and Adaptive Management: Summer 2022

▶ Phase 2: Lower Hole and Old Ranch Creeks

- ▶ 30% Designs
- ▶ Construction: Fall 2022 - Fall 2023
- ▶ Start Monitoring and Adaptive Management: Fall 2023

- CEQA
 - Completed for all four restoration sites
- Permitting
 - Phase 1 Sites
 - LSAA (CDFW): Operation of Law (Op Law)
 - Section 401 Compliance (RWQCB)
 - Anza: Complete
 - Hidden Valley: In progress
 - CWA Section 404 Compliance (USACE)
 - Section 7 Federal ESA Consultation Initiated with USFWS
 - Phase 2 Sites
 - After Phase 1 Site permits are obtained

Tributary Restoration Projects



Anza Creek Site in need of restoration
(Nov 29, 2018)



Old Ranch Creek Site after recent fire
(Feb 2, 2020)

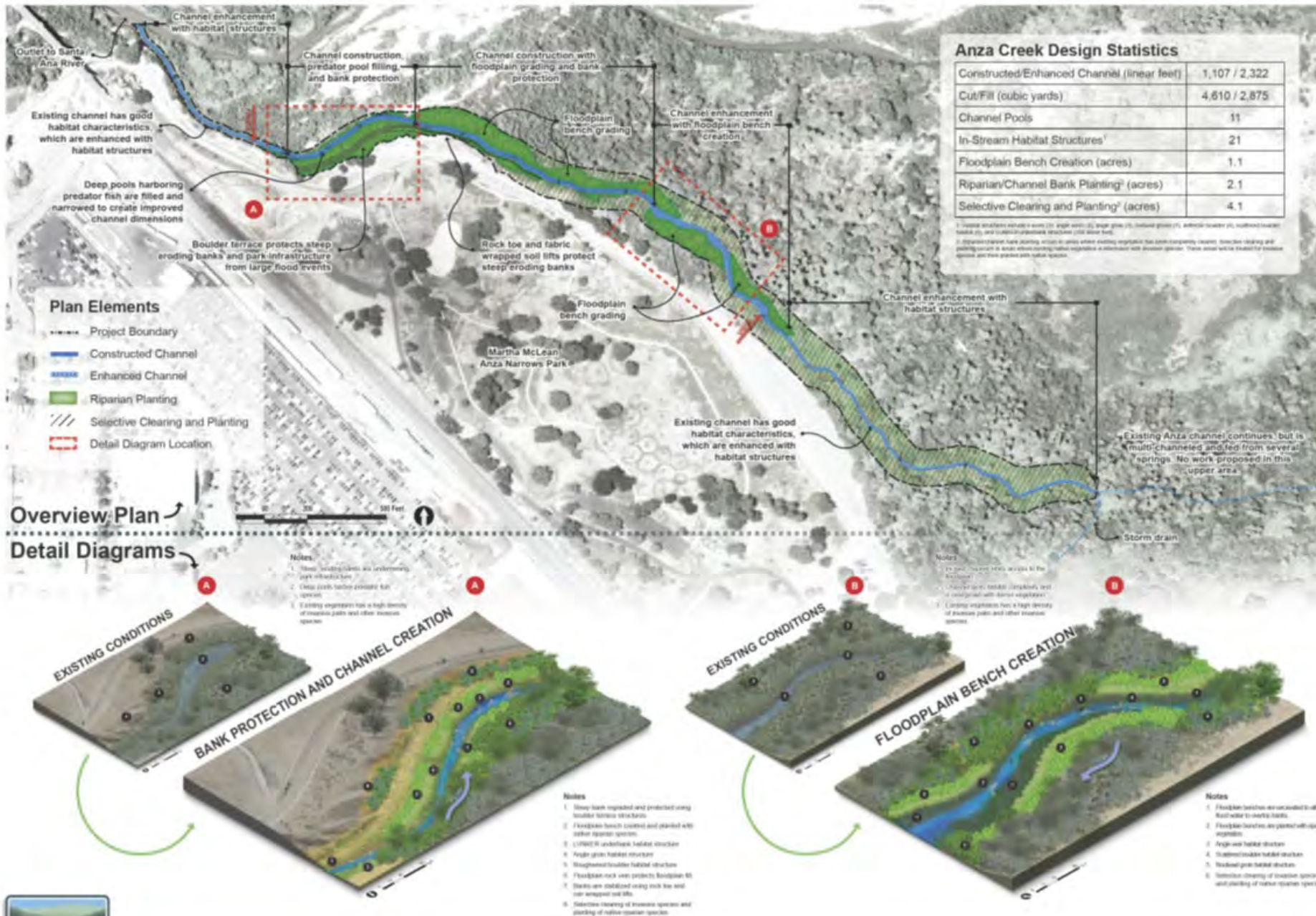

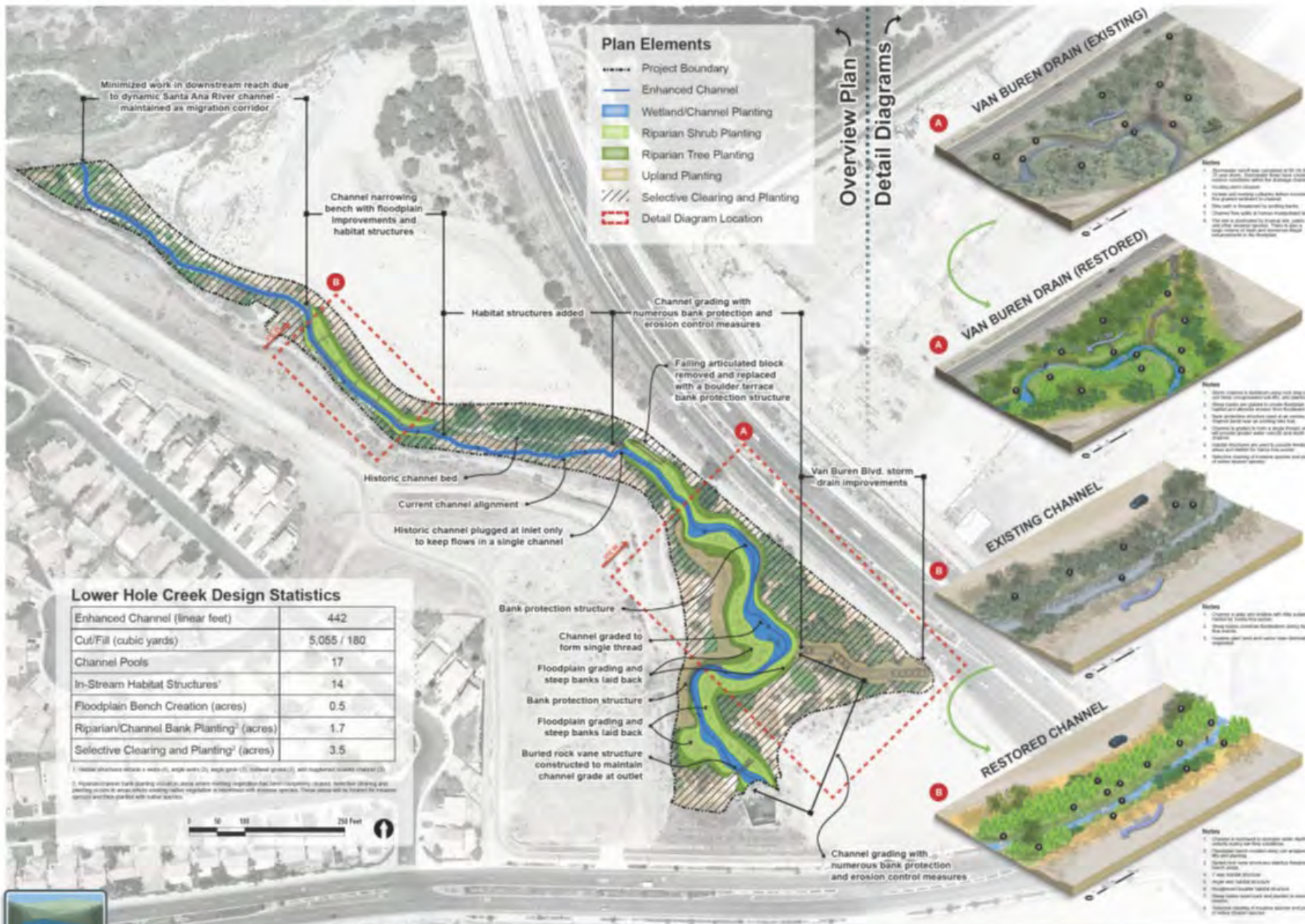

Lower Hole Creek Design Statistics

Enhanced Channel (linear feet)	442
Cut/Fill (cubic yards)	5,055 / 180
Channel Pools	17
In-Stream Habitat Structures ¹	14
Floodplain Bench Creation (acres)	0.5
Riparian/Channel Bank Planting ² (acres)	1.7
Selective Clearing and Planting ² (acres)	3.5

¹ Habitat structures include: weirs (1), single vane (1), single gate (1), boulder terrace (1), and rock vane (1) structure (1).
² Riparian/Channel Bank Planting includes: native shrub planting (14,000), native tree planting (14,000), native shrub planting (14,000), and native tree planting (14,000). These areas will be planted with native riparian vegetation and herbaceous plants.



Lower Hole Creek Restoration
 San Bernardino Valley Municipal Water District

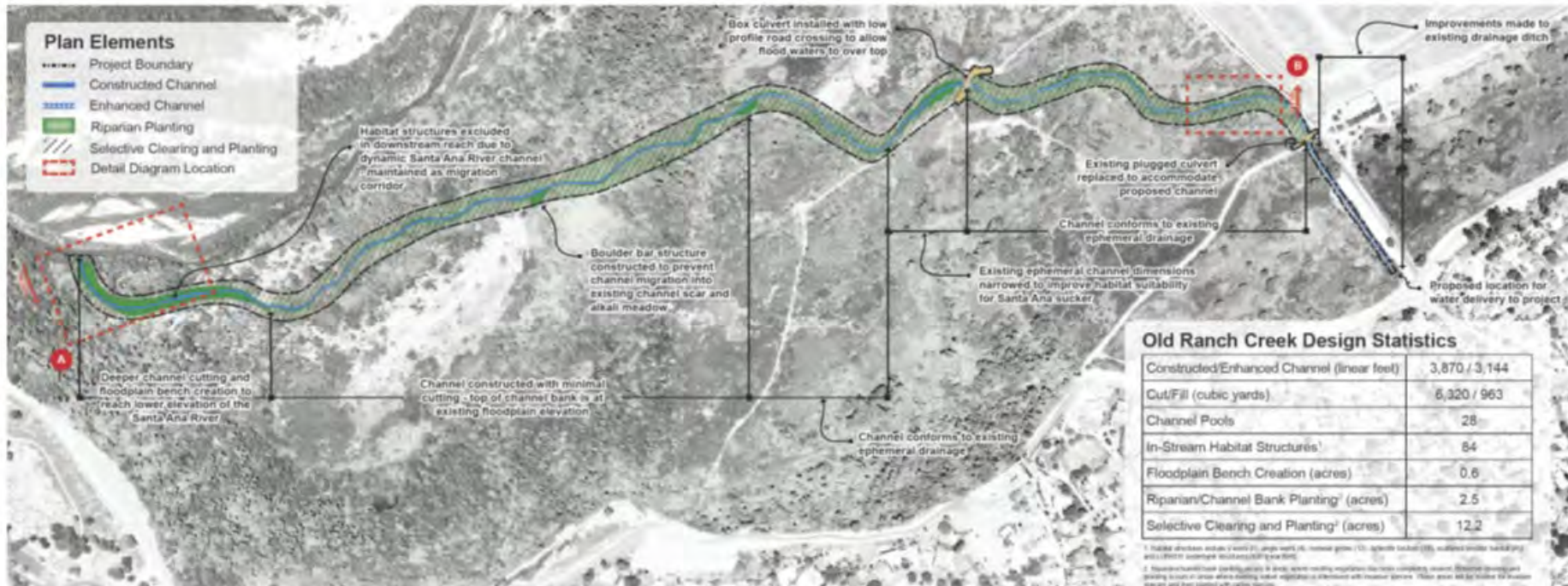

Old Ranch Creek Design Statistics

Constructed/Enhanced Channel (linear feet)	3,870 / 3,144
Cut/Fill (cubic yards)	6,320 / 963
Channel Pools	28
In-Stream Habitat Structures ¹	84
Floodplain Bench Creation (acres)	0.6
Riparian/Channel Bank Planting ² (acres)	2.5
Selective Clearing and Planting ² (acres)	12.2

¹ Habitat structure includes: 1) rock weirs, 2) log weirs, 3) log rafts, 4) log bridges, 5) brush piles, 6) brush dams, 7) brush structures, 8) brush structures, 9) brush structures, 10) brush structures, 11) brush structures, 12) brush structures, 13) brush structures, 14) brush structures, 15) brush structures, 16) brush structures, 17) brush structures, 18) brush structures, 19) brush structures, 20) brush structures, 21) brush structures, 22) brush structures, 23) brush structures, 24) brush structures, 25) brush structures, 26) brush structures, 27) brush structures, 28) brush structures, 29) brush structures, 30) brush structures, 31) brush structures, 32) brush structures, 33) brush structures, 34) brush structures, 35) brush structures, 36) brush structures, 37) brush structures, 38) brush structures, 39) brush structures, 40) brush structures, 41) brush structures, 42) brush structures, 43) brush structures, 44) brush structures, 45) brush structures, 46) brush structures, 47) brush structures, 48) brush structures, 49) brush structures, 50) brush structures, 51) brush structures, 52) brush structures, 53) brush structures, 54) brush structures, 55) brush structures, 56) brush structures, 57) brush structures, 58) brush structures, 59) brush structures, 60) brush structures, 61) brush structures, 62) brush structures, 63) brush structures, 64) brush structures, 65) brush structures, 66) brush structures, 67) brush structures, 68) brush structures, 69) brush structures, 70) brush structures, 71) brush structures, 72) brush structures, 73) brush structures, 74) brush structures, 75) brush structures, 76) brush structures, 77) brush structures, 78) brush structures, 79) brush structures, 80) brush structures, 81) brush structures, 82) brush structures, 83) brush structures, 84) brush structures, 85) brush structures, 86) brush structures, 87) brush structures, 88) brush structures, 89) brush structures, 90) brush structures, 91) brush structures, 92) brush structures, 93) brush structures, 94) brush structures, 95) brush structures, 96) brush structures, 97) brush structures, 98) brush structures, 99) brush structures, 100) brush structures.

² Riparian/Channel Bank Planting includes: 1) brush structures, 2) brush structures, 3) brush structures, 4) brush structures, 5) brush structures, 6) brush structures, 7) brush structures, 8) brush structures, 9) brush structures, 10) brush structures, 11) brush structures, 12) brush structures, 13) brush structures, 14) brush structures, 15) brush structures, 16) brush structures, 17) brush structures, 18) brush structures, 19) brush structures, 20) brush structures, 21) brush structures, 22) brush structures, 23) brush structures, 24) brush structures, 25) brush structures, 26) brush structures, 27) brush structures, 28) brush structures, 29) brush structures, 30) brush structures, 31) brush structures, 32) brush structures, 33) brush structures, 34) brush structures, 35) brush structures, 36) brush structures, 37) brush structures, 38) brush structures, 39) brush structures, 40) brush structures, 41) brush structures, 42) brush structures, 43) brush structures, 44) brush structures, 45) brush structures, 46) brush structures, 47) brush structures, 48) brush structures, 49) brush structures, 50) brush structures, 51) brush structures, 52) brush structures, 53) brush structures, 54) brush structures, 55) brush structures, 56) brush structures, 57) brush structures, 58) brush structures, 59) brush structures, 60) brush structures, 61) brush structures, 62) brush structures, 63) brush structures, 64) brush structures, 65) brush structures, 66) brush structures, 67) brush structures, 68) brush structures, 69) brush structures, 70) brush structures, 71) brush structures, 72) brush structures, 73) brush structures, 74) brush structures, 75) brush structures, 76) brush structures, 77) brush structures, 78) brush structures, 79) brush structures, 80) brush structures, 81) brush structures, 82) brush structures, 83) brush structures, 84) brush structures, 85) brush structures, 86) brush structures, 87) brush structures, 88) brush structures, 89) brush structures, 90) brush structures, 91) brush structures, 92) brush structures, 93) brush structures, 94) brush structures, 95) brush structures, 96) brush structures, 97) brush structures, 98) brush structures, 99) brush structures, 100) brush structures.

Overview Plan

Detail Diagrams



Old Ranch Creek Restoration

San Bernardino Valley Municipal Water District

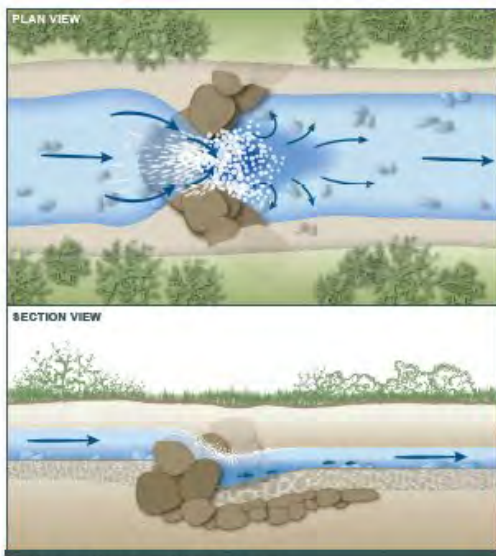

CENTER WEIR PLUNGE POOL

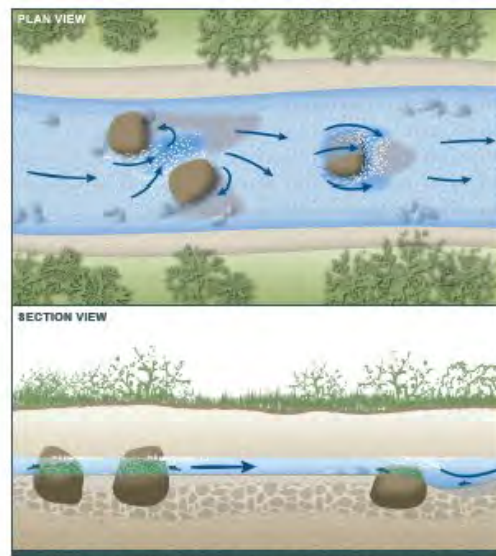

BOULDER-ROUGHENED RIFFLE/RUN HABITAT

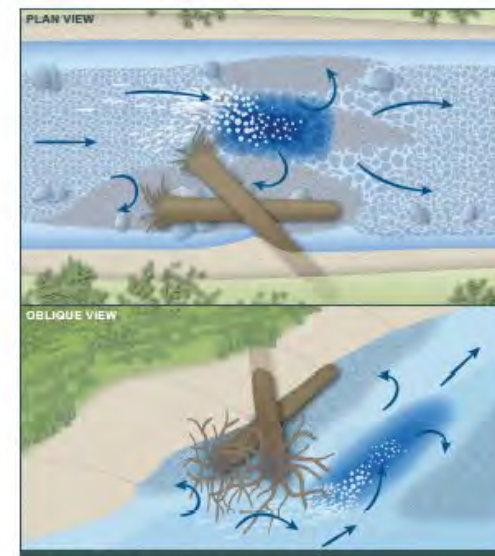

ROOT WAD GROIN SCOUR POOL

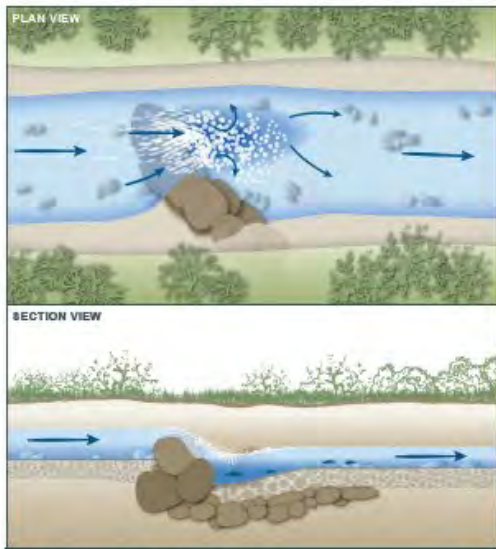

ANGLE WEIR PLUNGE POOL

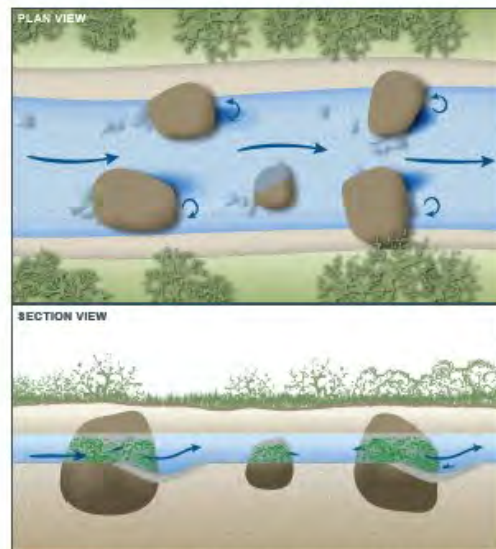

SCATTERED BOULDERS IN SLACKWATER POOLS

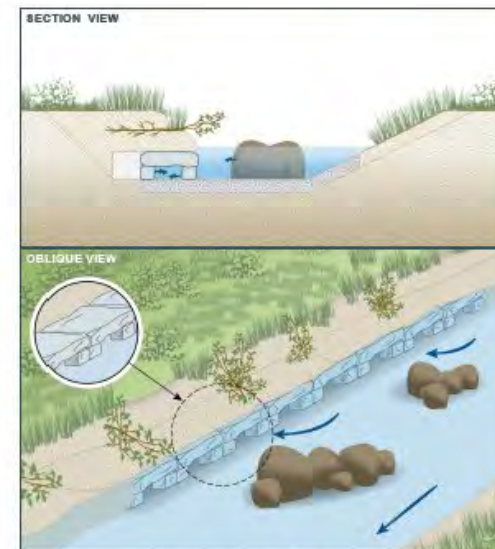

LUNKER UNDERBANK HABITAT STRUCTURE



SAWPA Updates



Water Use Efficiency Budget Assistance Task

Purpose of Task

- ▶ Help 10 retail agencies comply with State regulations* that require water agencies to adhere to agency-wide water use efficiency budgets;
 - ▶ Side benefit: Provides retail agencies with mapping data to target their existing water use efficiency programs to inefficient water users.

Dedicated Landscape Meter Customer Example



* Senate Bill 606 and Assembly Bill 1668

Latest Progress

- ▶ **February 2021:** Recommended consultant contract to PA 22 Committee,
- ▶ **March 2021:** Kick-off meeting with SAWPA member agencies, MWDOC and consultant team composed of:
 - ▶ Quantum Spatial,
 - ▶ Eagle Aerial,
 - ▶ Waterfluence.
- ▶ **Next steps:** Workshops in April to recruit the retail water agency partners.
- ▶ **End of schedule:** February 2023.

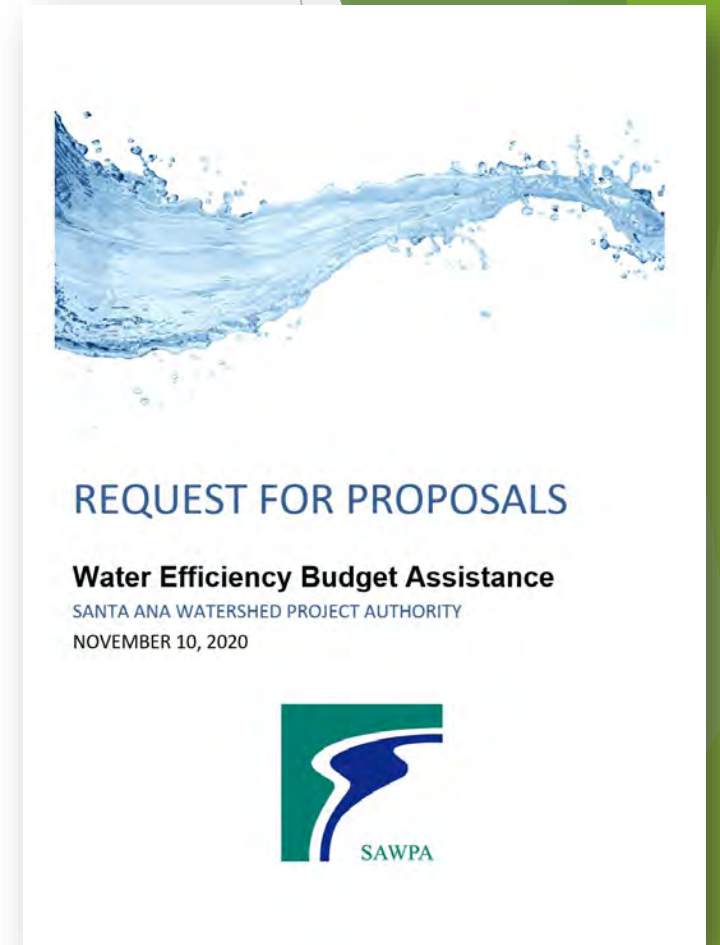

Questions





SARCCUP Schedule

Brian Dietrick, Woodard & Curran

PA 23 Committee | April 6, 2021

Item No. 4.B.



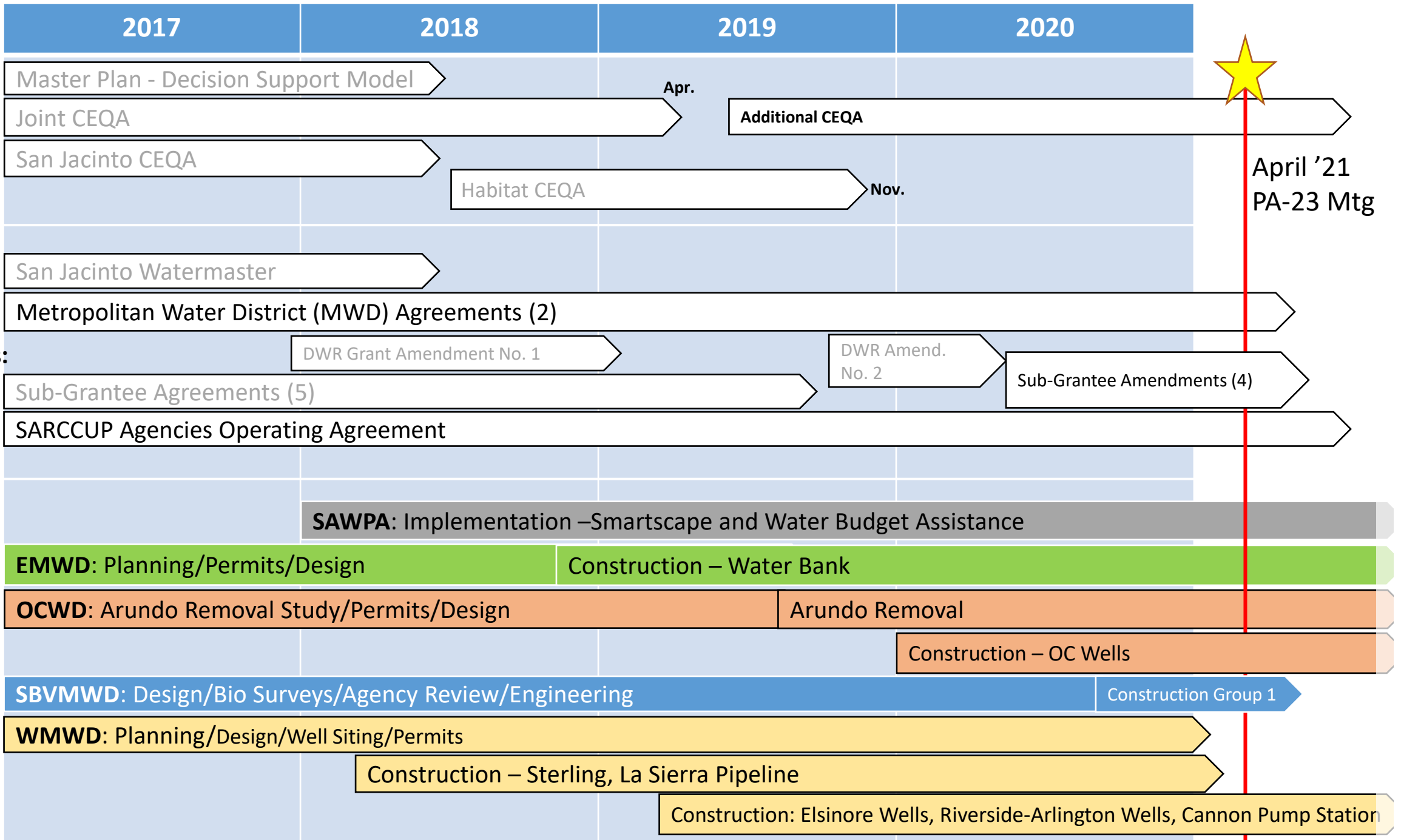

April '21
PA-23 Mtg

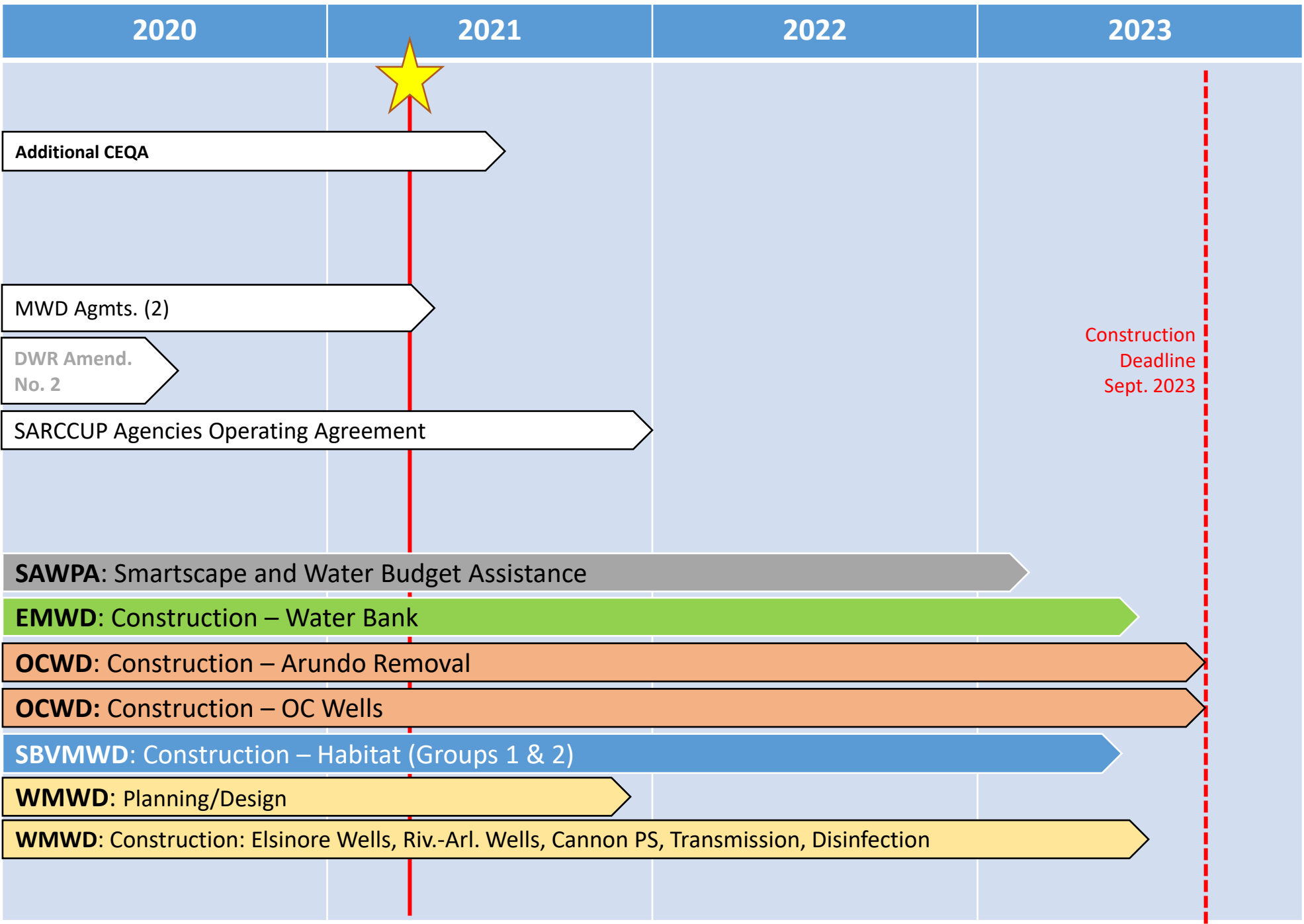

**Planning/
CEQA:**

Additional CEQA



2021

2022

2023

**Key
Agreements:**

MWD Agmts. (2)

DWR Amend.
No. 2

SARCCUP Agencies Operating Agreement

Construction
Deadline
Sept. 2023

Projects:

SAWPA: Smartscape and Water Budget Assistance

EMWD: Construction – Water Bank

OCWD: Construction – Arundo Removal

OCWD: Construction – OC Wells

SBVMWD: Construction – Habitat (Groups 1 & 2)

WMWD: Planning/Design

WMWD: Construction: Elsinore Wells, Riv.-Arl. Wells, Cannon PS, Transmission, Disinfection

2020-2023 Agency Slides

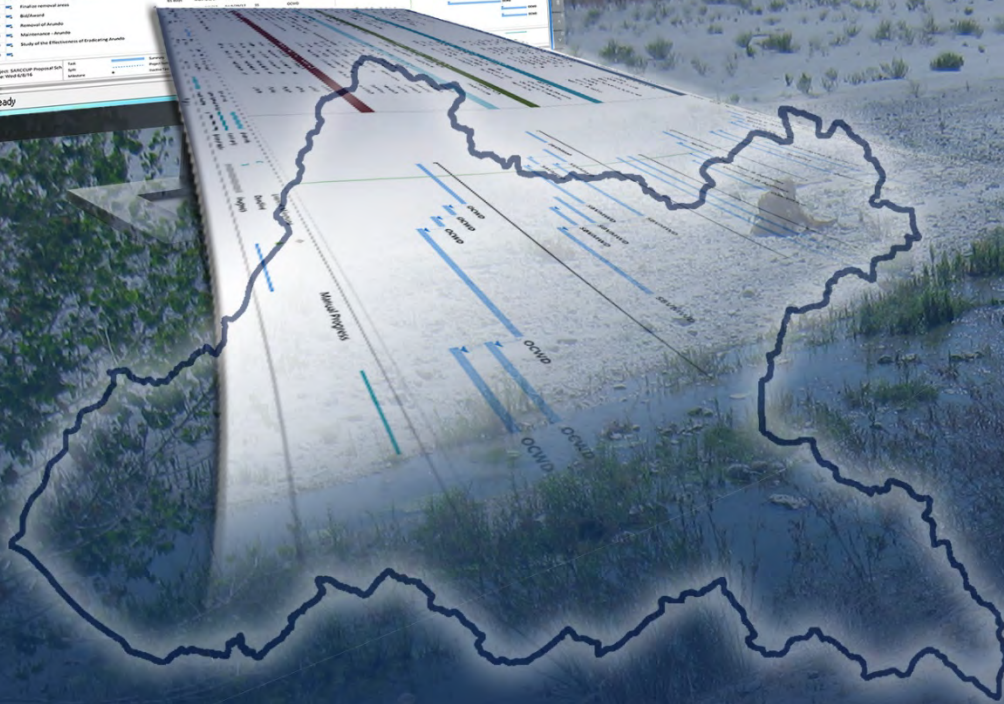
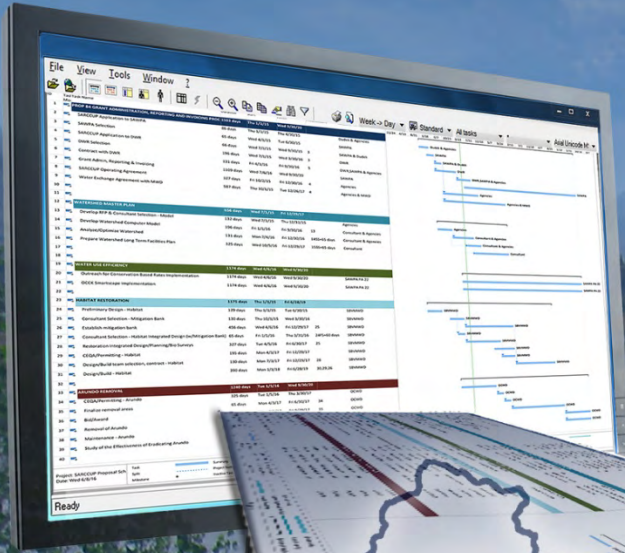

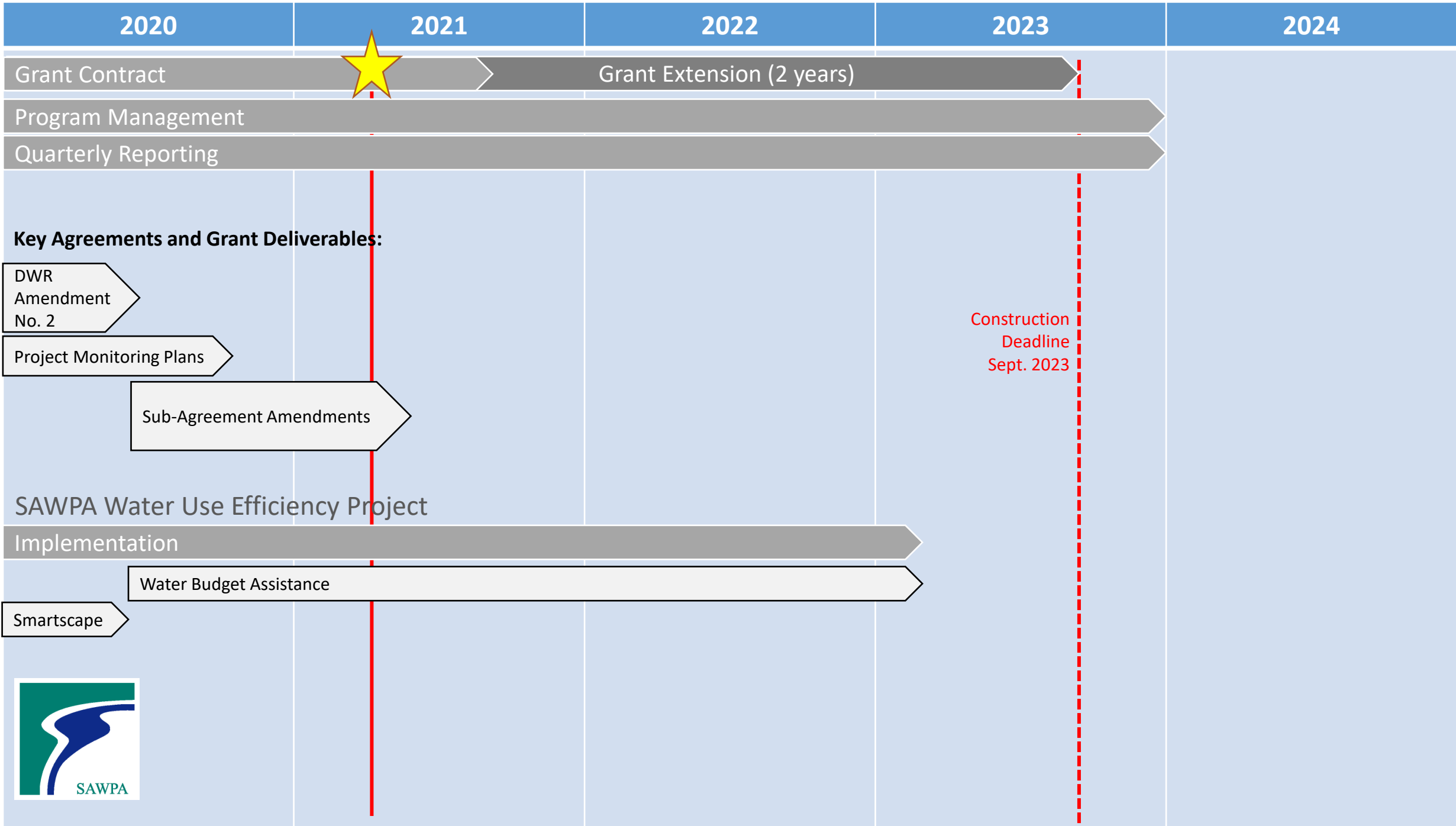

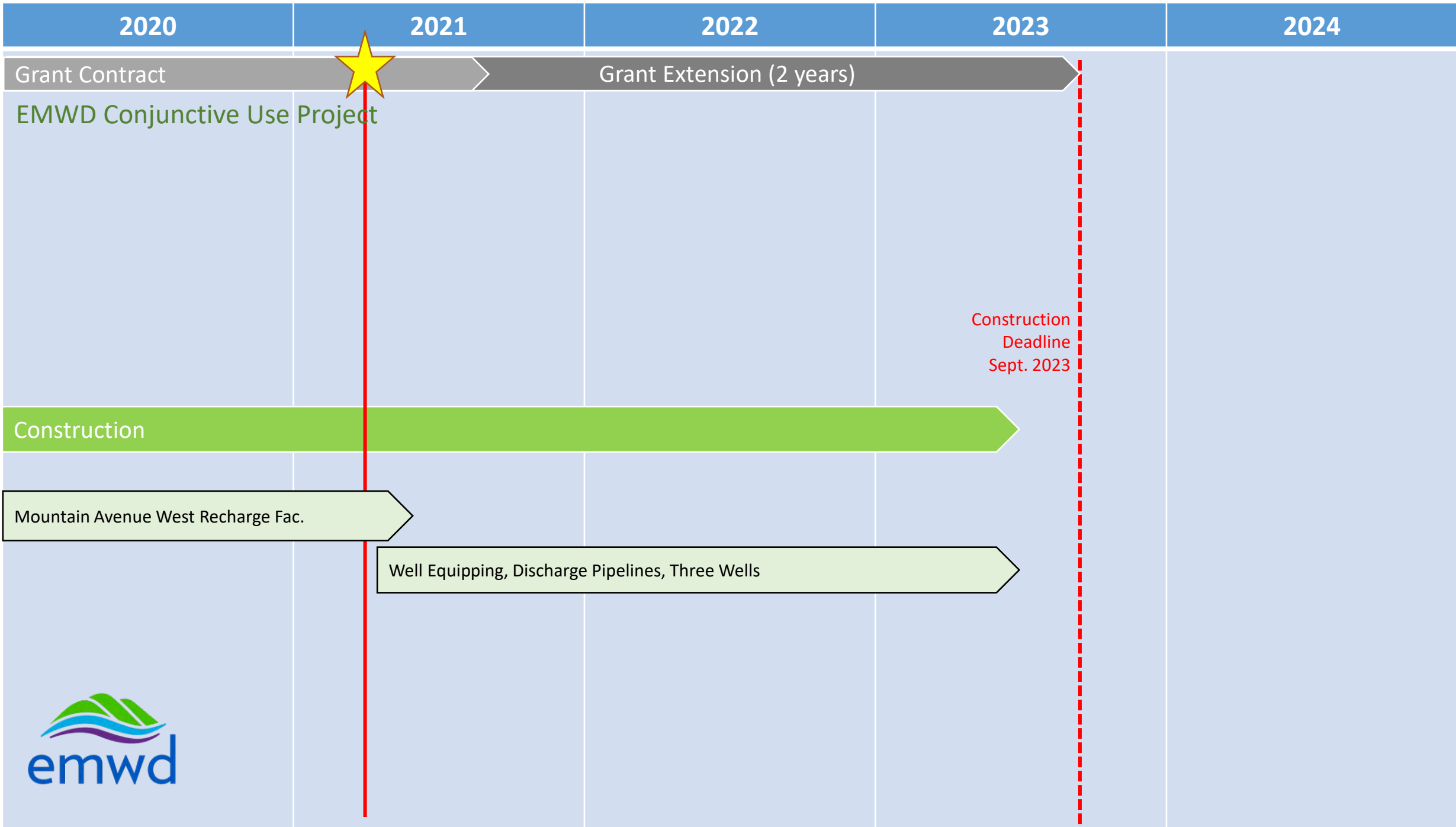

2020

2021

2022

2023

2024

Grant Contract

Grant Extension (2 years)

EMWD Conjunctive Use Project

Construction

Mountain Avenue West Recharge Fac.

Well Equipping, Discharge Pipelines, Three Wells

Construction
Deadline
Sept. 2023



2020	2021	2022	2023	2024
------	------	------	------	------

Grant Contract Grant Extension (2 years)



OCWD Arundo Removal Project

Construction
Deadline
Sept. 2023

Construction – Arundo Removal

Construction – OC Wells



2020 2021 2022 2023 2024

Grant Contract Grant Extension (2 years)



SBVMWD Habitat Restoration Project

Habitat Permits

Establish Mitigation Bank

Final Engineering/ Construction Package 1 Construction Group 1

Final Engineering/ Construction Package 2 Construction Group 2

Construction Deadline
Sept. 2023



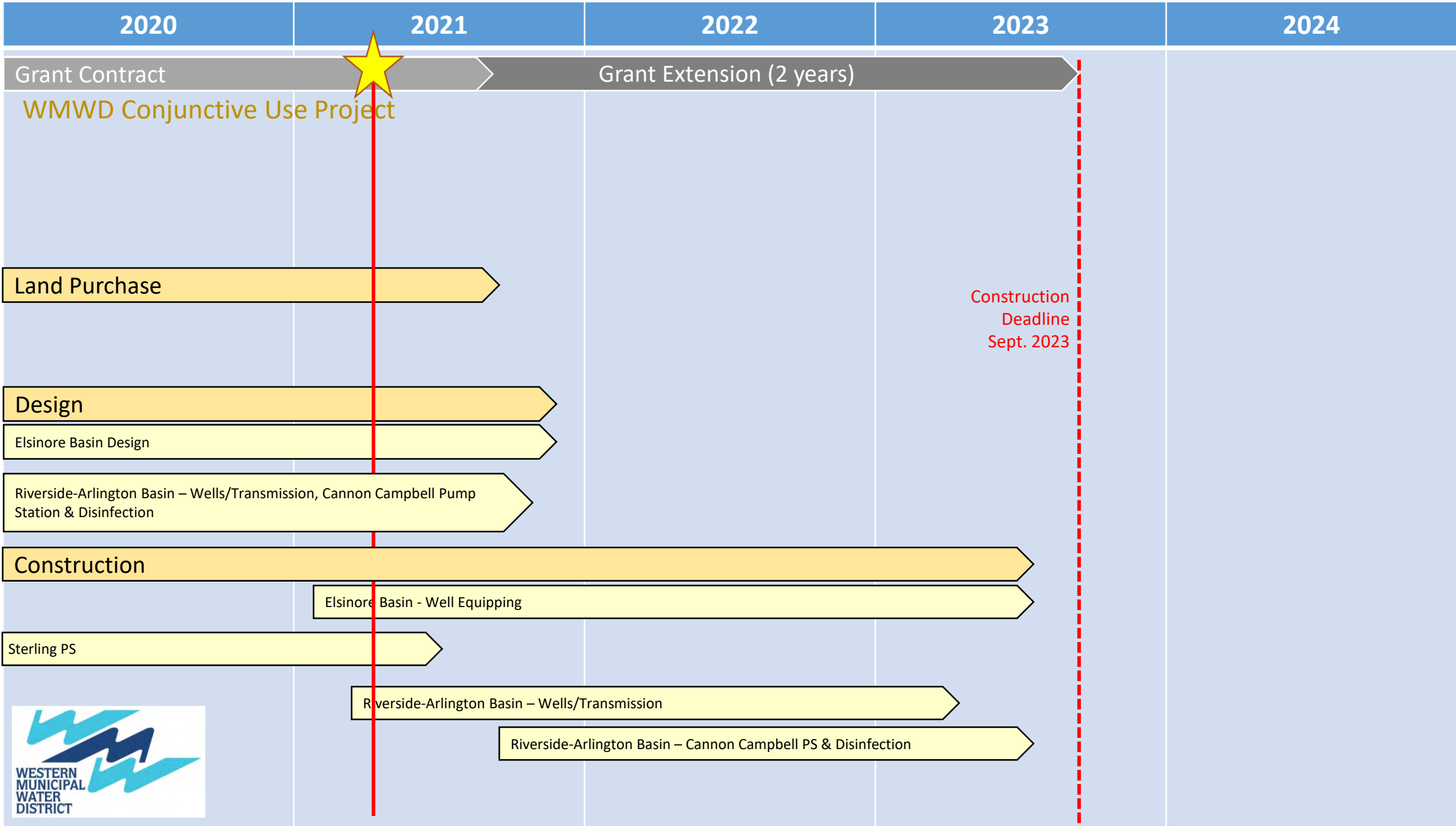



SARCCUP Grant Payment Updates

Ian Achimore, Senior Watershed
Manager

PA 23 Committee | April 6, 2021

Item No. 4.C.



Background on Grant

- ▶ Department of Water Resources adopted grant agreement amendment No. 2 with SAWPA on May 29, 2020.
 - ▶ PA 23 Committee adopted grant amounts (as shown on next slides) at the April 2 and October 1, 2019 Committee meetings, which were incorporated into the amendment with DWR.
- ▶ Amounts shown in this presentation reflect invoices submitted through **December 31, 2020** (latest invoices received at time of publishing this agenda packet).
- ▶ As of December 31, 2020, the amount of grant invoiced is 42% of the total \$55M grant.



Grant Payment Status By SARCCUP Agency (Percent of Total Grant Invoiced Shown)

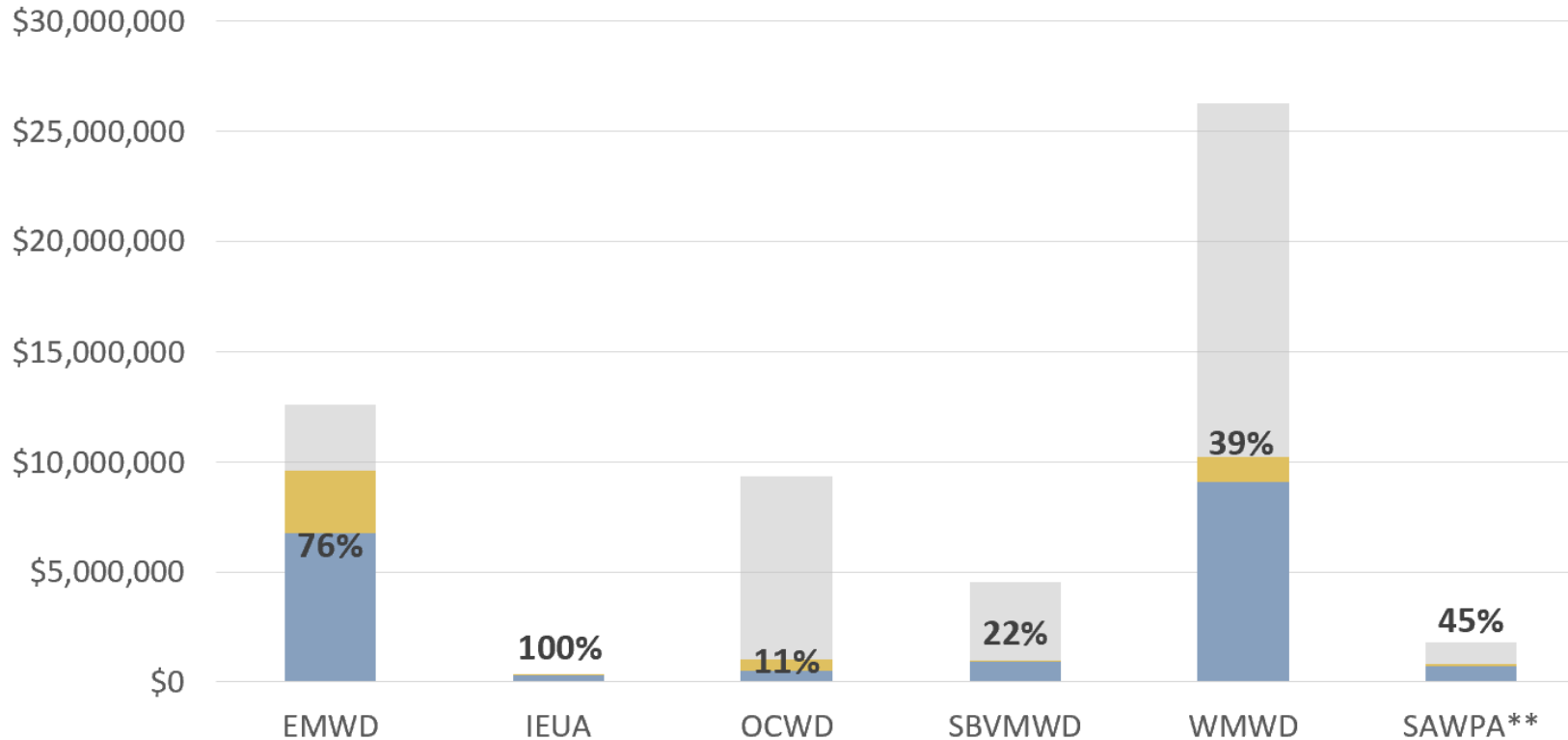

Notes:

*Payment outstanding due to 10% retention withheld on each grant amount included in invoice, or lag in payment from last quarter's invoice.

**Includes funding for Woodard & Curran and Water Use Efficiency Tasks.

	EMWD	IEUA	OCWD	SBVMWD	WMWD	SAWPA**
Grant Paid	\$6,757,914	\$330,706	\$521,246	\$942,516	\$9,101,422	\$706,897
Total Outstanding Grant Payments*	\$2,858,899	\$36,745	\$512,456	\$57,256	\$1,010,412	\$93,412
Total Grant (DWR Amendment No. 2)	\$12,621,835	\$367,968	\$9,368,344	\$4,565,932	\$26,283,723	\$1,792,199

More Detail on Outstanding Grant Payments (Through December 31, 2020)

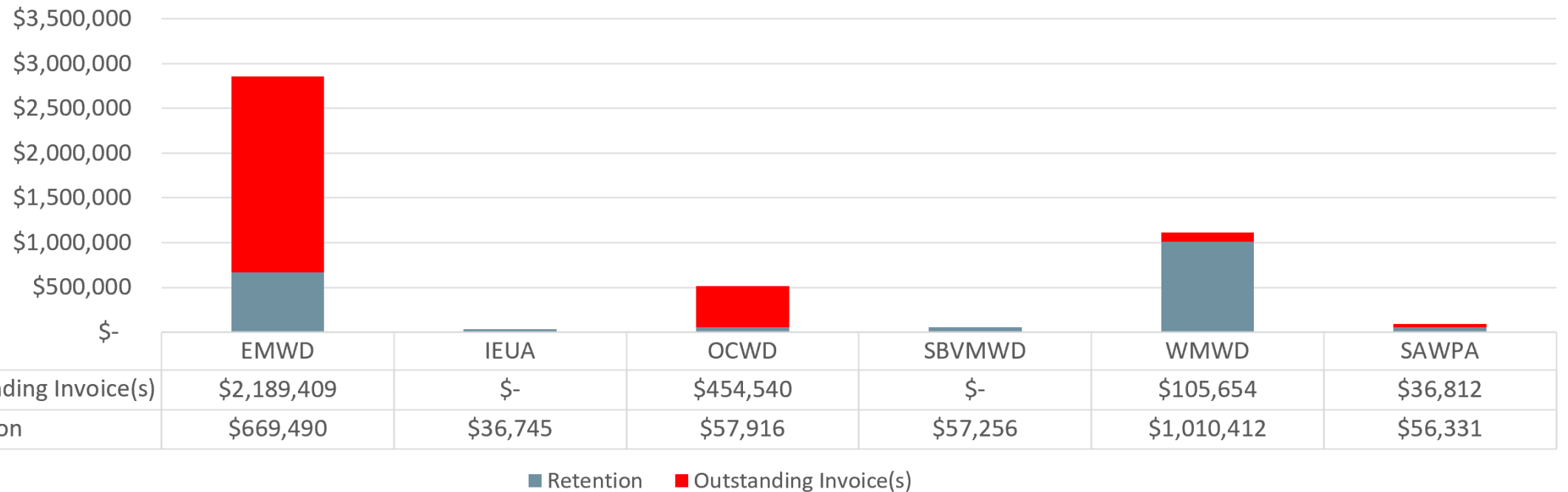

Notes:

- Retention will be withheld by DWR until complete invoicing of overall SARCCUP Project (scheduled for December 2023).
- Last paid invoice from DWR was for reimbursing expenses incurred by SARCCUP agencies through June 30, 2020.

Project Agreement 23 Committee Budget for Fiscal Years Ending 2022 & 2023



Ian Achimore, Senior Watershed
Manager

PA 23 Committee | April 6, 2021

Item No. 4.D.



Important SARCCUP Milestones

- Received \$55M Prop 84 grant through OWOW process from Department of Water Resources (DWR)
SAWPA member agencies are lead project proponents for SARCCUP (they receive pass through funding from SAWPA)
- SAWPA Commission forms PA 23 Committee and SAWPA staff implement several SARCCUP components:
 - Water use efficiency portion
 - Woodard & Curran project manager contract
 - PA 22 and PA 23 committee management



PA 23 Budget



Relation to SAWPA Commission Budget

- PA 23 budget required per Section 10 of Project Agreement
- PA 23 budget is also inserted into SAWPA two year budget
 - SAWPA two year budget is up for adoption at April 20 Commission meeting
 - PA 22 Committee budget is also within SAWPA budget
- Adoption of budget by member agencies allows SAWPA staff to invoice member agencies for SARCCUP water use efficiency and project management tasks

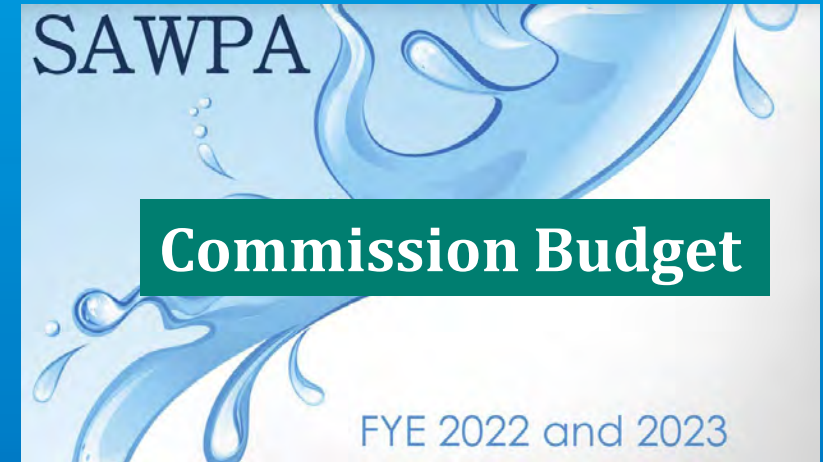

Origin of \$ Values in Committee Budget

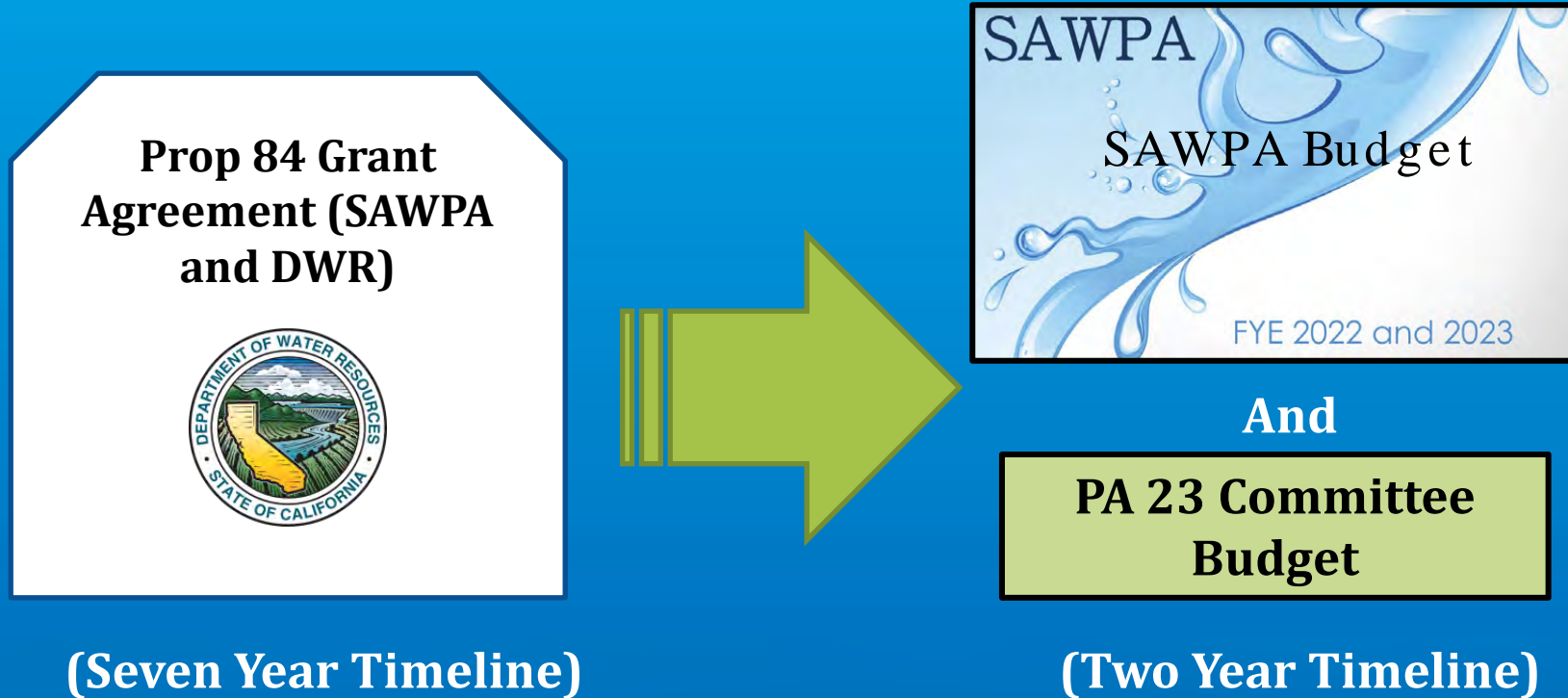

Separate Documents for SARCCUP Funding

Prop 84 Grant Agreement



Purpose

Transfer grant funding and track local match

Purpose

Committee makes management decision on project



Grant Agreement Budget



Prop 84 Grant Agreement

Total Cost in Grant Agreement:
\$150,014,117

Task List in Grant Agreement:

- Habitat
- Conjunctive Use
- Project and Committee management
- Water Use Efficiency

PA 23 Budget

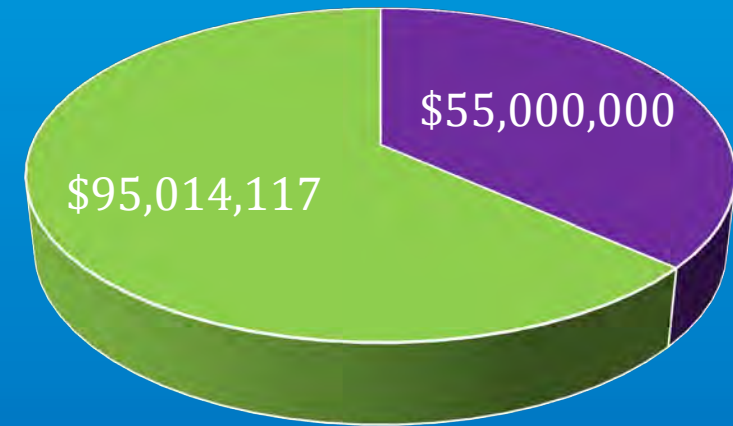

■ Grant ■ Local Match



SARCCUP Project and Committee Management

- SAWPA staff also manages the preparation and materials for both the PA 22 and PA 23 Committees
 - Planning agenda materials,
 - Coordinating items that require management approval with the SARCCUP project proponents,
 - Brought new water use efficiency proposal for approval.
- SAWPA manages the contract with Woodard and Curran (W&C) which does the following:
 - Coordinates/reviews the invoicing DWR,
 - Facilitates bi-weekly SARCCUP planning managers meetings,
 - Maintains schedule and deliverable tracking.



SARCCUP Water Use Efficiency

- Contains two components:
 - Smartscape Program
 - Water Efficiency Budget Assistance
- Both involve SAWPA working with outside entities
 - Orange County Coastkeeper implemented water audits, landscape design assistance.
 - Quantum Spatial recently executed contract with SAWPA to implement Water Efficiency Budget Assistance with 10 retailers.

Water Efficiency Budget Assistance

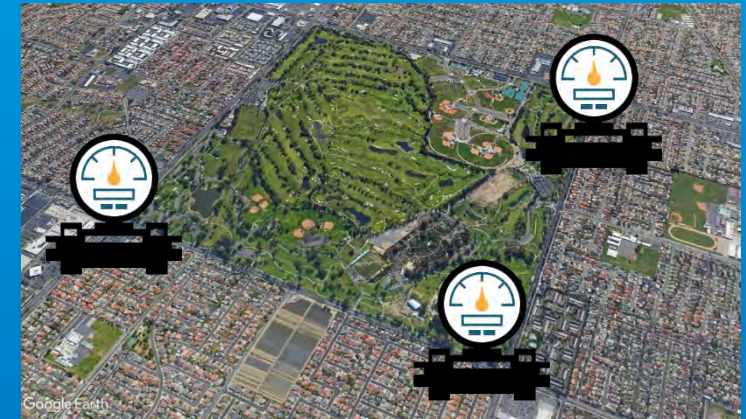

Recommended Committee Budget

Revenues

Budget Line Item	Current Two Year Budget		This Two Year Budget	
	FYE 2020	FYE 2021	FYE 2022	FYE 2023
Prop 84 Grant	\$455,144	\$515,850	\$337,313	\$136,370
Participant Fees	\$503,990	\$463,292	\$433,512	\$160,000
TOTAL	\$959,134	\$979,142	\$770,825	\$296,370

Expenses

Budget Line Item	Current Two Year Budget		This Two Year Budget	
	FYE 2020	FYE 2021	FYE 2022	FYE 2023
SAWPA Labor	\$294,251	\$355,868	\$139,978	\$154,310
W&C Project Mgmt Consulting	\$257,114	\$215,505	\$170,000	\$160,000
Legal Fees	\$0	\$0	\$1,300	\$1,300
Water Use Efficiency Projects	\$407,769	\$407,769	\$459,547	\$367,637
Water Budgets (Formerly Water Rates)	\$332,093	\$332,093	\$459,547	\$367,637
Smartscape Program	\$75,677	\$75,677	\$0	\$0
TOTAL	\$959,134	\$979,142	\$770,825	\$683,247

Note: Revenue/expenses don't match for FYE 2023 due to carryover revenue funding.

Budget Comparison

 Revenues	Current Two Year Budget		Comparison to Current	
	Adopted	Adopted	Actual	Projected
	FYE 2020	FYE 2021	FYE 2020	FYE 2021
Budget Line Item				
Prop 84 Grant Spent	\$455,144	\$515,850	\$166,668	\$85,122
Participant Fees Invoiced	\$503,990	\$463,292	\$503,990	\$463,292
TOTAL	\$959,134	\$979,142	\$670,658	\$548,414

 Expenses	Current Two Year Budget		Comparison to Current	
	Adopted	Adopted	Actual	Projected
	FYE 2020	FYE 2021	FYE 2020	FYE 2021
Budget Line Item				
SAWPA Labor	\$294,251	\$355,868	\$69,131	\$85,122
W&C Project Mgmt Consulting	\$257,114	\$215,505	\$164,537	\$79,452
Legal Fees	\$0	\$0	\$0	\$1,340
WUE Projects	\$407,769	\$407,769	\$153,049	\$91,909
Water Budgets (Formerly Water Rates)	\$332,093	\$332,093	\$0	\$91,909
Smartscape Program	\$75,677	\$75,677	\$153,049	\$0
TOTAL	\$959,134	\$979,142	\$386,717	\$257,823

Note: Revenue/expenses don't match for FYE 2023 due to carryover revenue funding.

SARCCUP Grant Pass Through Funding

Not a Committee Budget

Expenditure Projections by SARCCUP Agencies

	Current Two Year Budget		This Two Year Budget	
	Actual	Projected	Proposed	Proposed
SAWPA Member Agency	FYE 2020	FYE 2021	FYE 2022	FYE 2023
EMWD	\$3,523,610	\$1,038,886	\$1,818,051	\$2,337,494
IEUA	\$338,109	\$0	\$0	\$0
OCWD	\$547,032	\$1,757,836	\$3,076,213	\$3,955,131
SBVMWD	\$9,137	\$713,232	\$1,248,156	\$1,604,772
WMWD	\$0	\$3,234,378	\$5,660,161	\$7,277,350
TOTAL	\$4,417,888	\$6,744,332	\$11,802,581	\$15,174,747



Recommendation

It is recommended that the Project Agreement 23 Committee adopt the PA 23 Committee Budget for Fiscal Years Ending 2022 and 2023.

